



Ballast for geothermal probe

Ballast for geothermal probes

Features

Materials

- FE 360 steel

Applications



Standards

Certifications

Dati tecnici

see table

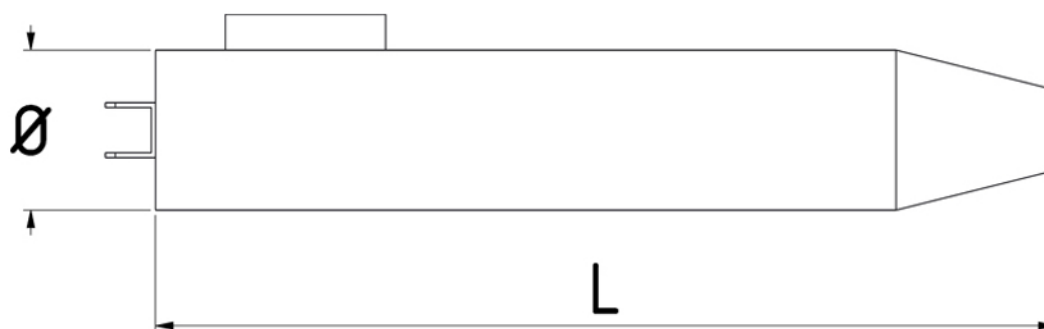

Dimensional

Cod	Ø (mm)	L (mm)	Weight (kg)
3230012000	80	300	12.00
3230024000	80	600	24.00

- For use with single or double head.
- Fitted with connection for push rod.
- Fitted with nuts, bolts and washers for connection to probe.
- Chamfered tip to facilitate the descent into the pit.